



1 Wicksted House County Street

, London, SE1 6RQ

£4,500 Per month



1 Wicksteed House County Street



Description

A large 5 bedroom flat with 2 bathrooms very close to Elephant and Castle underground station and all amenities in and around Elephant and Castle, ideal for students. It is conveniently located for Goldsmiths & Southbank University.

This fully furnished flat comes with five double bedrooms, a large communal lounge, separate kitchen and dining area, a family sized bathroom as well as separate shower and guest WC. Each bedroom is furnished with a double bed, wardrobe and drawers, so great for students.

The flat is 1 mile to Elephant and Castle Tube Station with direct trains into the city centre.

Available on a furnished basis from mid September.

- Property ideal for Ideal for students and sharers
- Rooms come part furnished
- 0.8 Miles to Elephant and Castle
- Separate shower room and toilet
- Excellent bus links
- 5 spacious bedrooms
- Reception room
- Local amenities
- 20 minute journey into the City centre
- Available from mid September





Floor Plan

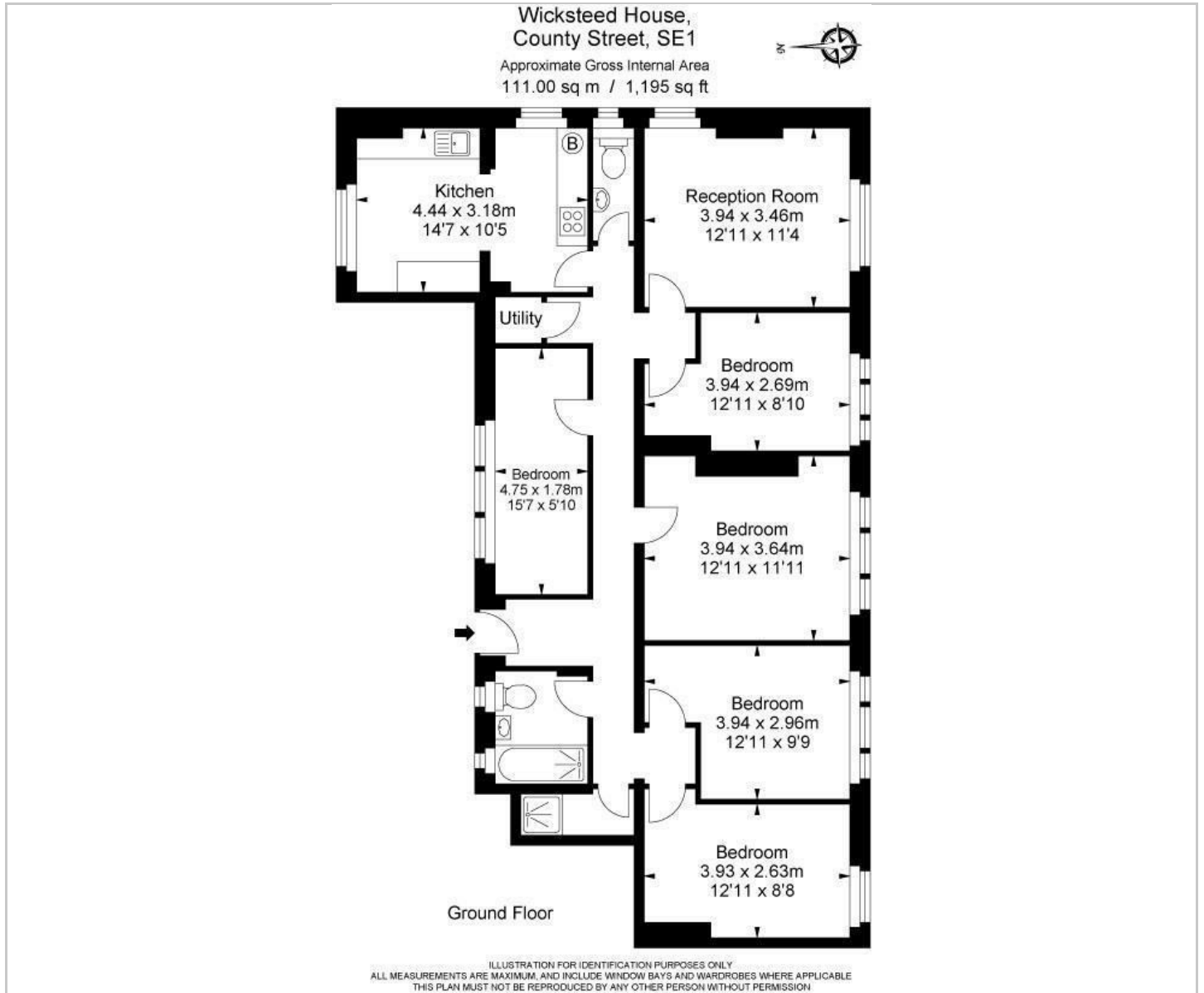

Energy Efficiency Rating		Current	Potential
Very energy efficient - lower running costs			
(92 plus) A			
(81-91) B			
(69-80) C			
(55-68) D			
(39-54) E			
(21-38) F			
(1-20) G			
Not energy efficient - higher running costs			
England & Wales		EU Directive 2002/91/EC	

Environmental Impact (CO ₂) Rating		Current	Potential
Very environmentally friendly - lower CO ₂ emissions			
(92 plus) A			
(81-91) B			
(69-80) C			
(55-68) D			
(39-54) E			
(21-38) F			
(1-20) G			
Not environmentally friendly - higher CO ₂ emissions			
England & Wales		EU Directive 2002/91/EC	

Viewing

Please contact our Head Office Office on 03333444385 if you wish to arrange a viewing appointment for this property or require further information.

These particulars, whilst believed to be accurate are set out as a general outline only for guidance and do not constitute any part of an offer or contract. Intending purchasers should not rely on them as statements of representation of fact, but must satisfy themselves by inspection or otherwise as to their accuracy. No person in this firm's employment has the authority to make or give any representation or warranty in respect of the property.

